



In designing and constructing our projects we focus on using the best quality materials in conjunction with latest technology. We are proud to provide smart environmentally friendly homes. Our projects require less maintenance, less operating costs, and reduces noise pollution that gives our clients tranquility.

Our water based multi color granite coating has been applied on projects around the world. We have had success in emulating actual stone at a fraction of the cost and time required of real stone products.



APPLICATION

- ✓ Building Facade
- ✓ Granite coating exterior wall
- ✓ Various style of beam and column.
Example: Roman column
- ✓ Suitable for a variety of surfaces and bases. Examples: cement base, metal plates such as aluminum wood, tile and glass etc.

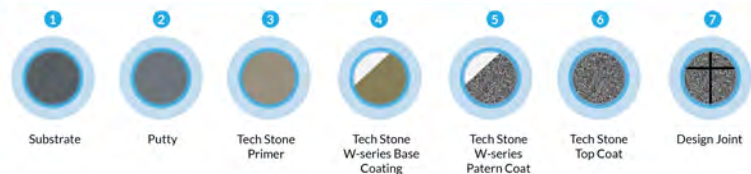
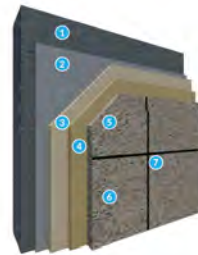

PRODUCT STRUCTURE

1. Base Material / Substrate
2. Primer
3. Base Coat
4. Pattern (Stone Coat)
5. Clear Top Coat

TECH STONE PRIMER

Apply with spray or roller
Amount use: 0.08-0.12 kg per m2
Allow 10-15% water content
Minimum of 3 hours drying after application

TECH STONE BASE COAT

Apply with spray or roller
Consumption: 0.15-0.25 kg per m2
Allow minimum of 12 hours drying after application



PRODUCT LIST



LIQUID GRANITE STONE

Liquid Granite Series is a water based multi color granite coating solution. Emulates an actual granite stone at a fraction of the cost and time required of real stone products, which gives designers great flexibility in creating designs that can adapt to the building concept.

Items Needed For Application



Paint Roller



Paint Spray Gun (3.0mm - 3.5mm)

Materials To Use

- Primer
- Water Repellant
- Base Paint
- Liquid Granite Series

Installation Guide

- 1 Apply a primer on the flat base surface.
- 2 Apply medium coating twice.
- 3 Spray main coating twice.
- 4 Apply a topcoat.

Technical Specification

Surface Drying Time:
About 4 Hour

Spreading Rate
About 1.5kg/m²

Construction Thickness
1mm/times

Package Specification
20KG / Barrel

HIGH GRANITE SIMULATION

Tech Stone, also known as Liquid Granite, is a water based multi-color coating system. It is a thick weather-shield with inorganic stone materials combined with high-technology water resin which is an excellent alternative for natural granite.

ADAPTIVE ARCHITECTURAL DESIGN

Tech Stone is not limited to flat surfaces, It can also be applied to all surface shapes which makes it ideal for a lot architectural designs and form where one could achieve the desired granite-like effect.

Step 1 **Surface Preparation**
Ensure the Newly Prepared Surfaces are Dry and even.

Step 2 **Priming Procedures:**
Coat the wall with a layer of primer to conceal the old color and help achieve better coverage with the new coating

Step 3 **(Optional) Design Joint Preparation:**
Layout Preferred Design Joint.

Step 4 **(Optional) Mask over Design Joint with Masking Tape.**

Step 5 **Base Coating:**
Apply Base Coat to better achieve the desired Pattern color.

Step 6 **Tech Stone Pattern Coat Application:**
Spray Application of Tech Stone Liquid Granite Coating. Preferably two coats to achieve desired results.

Step 7 **Removing Masking Tape:**
Remove Masking tape to reveal the Design Joint.

Step 8 **Application of Water Repellant Top Coat:**
Apply TechStone Water Repellant Top Coat for final step to add protection and achieve long-lasting durability of coating.